

# Rental Guide



The Museum of Vancouver is a unique and important historical venue. Built for Canada's centennial and opened in 1968, the building is **one of Vancouver's architectural gems**, making it a one-of-a-kind venue to host a myriad of special events, receptions and meetings.

Situated in **Vanier Park** near **Kitsilano Beach**, just minutes from downtown, the Museum boasts stellar views of English Bay, Stanley Park, and the North Shore mountains.

The Museum's variety of special exhibitions and programs means there's always an inspiring energy within its walls. Our dedicated Rentals department strives to provide you and your guests with exceptional service and a memorable event experience.

## Introduction



# Contents

## Venues

Joyce Walley Room  
Garden Patio & History Room

## Prices

Rental Capacities  
Pricing

## More

Catering



## Venues

The Museum of Vancouver has two major rental spaces; the **Joyce Walley Room** and the **Garden Patio & History Room**.

### Joyce Walley Room

Our multipurpose space. The space features 13-foot floor-to-ceiling windows making it an ideal location for various events.

### Garden Patio & History Room

The Garden Patio and adjacent History Room feature unobstructed views of Vanier Park, English Bay, the West End, Stanley Park and the North Shore mountains.



# Joyce Walley Room

The Joyce Walley Room is our **multipurpose indoor space**. The space features **13-foot floor-to-ceiling windows** for unparalleled views of Vanier Park, English Bay, the West End, Stanley Park and the North Shore mountains.

## Capacity

Standing Cocktail Reception	140
Wedding Ceremony	120
Theatre/Lecture Style	120
Seated Dining	90

## Ideal for

Wedding ceremonies and receptions, corporate events, meetings, conferences, a celebration of life, social events, reunions, anniversaries, openings, youth events and camps.

## Pricing

\$370 an hour  
Minimum four hour rental





### Included Amenities

Event liaison, security, building services staff, event storage space, site visit, signage and photo opportunities.

### A/V & Furniture

Podium with built in microphone plus one additional audio channel, Wi-Fi, large projection screen, projector, access to 20 six-foot rectangular banquet tables, and 110 black contemporary stacking chairs.

## Joyce Walley Room

*Vanier Park, English Bay, and the North Shore mountains  
through a panoramic wall of glass*



Floor Plan

# Joyce Walley Room

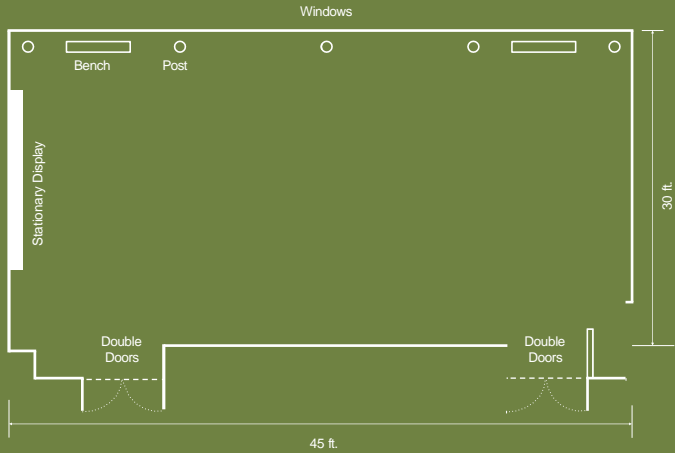

Example A: 90 seats

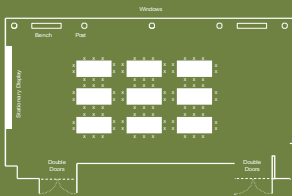

Example B: 50 seats

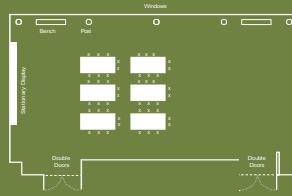





Native Plant Garden

Vanier Park

Duck ponds

## Garden Patio & History Room

The Garden Patio and adjacent History Room feature unobstructed views of Vanier Park, English Bay, the West End, Stanley Park and the North Shore mountains. The venue is located on the lower level of the Museum and the Patio itself is surrounded by our Native Plant Garden. Its location is only steps away from the duck ponds, bike paths and overlooks the open green space of Vanier Park. The History Room and Garden Patio are ideal for e looking to incorporate **both indoor and outdoor space**. It also features dual door access to the Patio, which are perfect for wedding ceremonies and special entrances.

### Capacity

The Garden Patio & History room are *two spaces* rented as one. Capacities depend on whether your event requires the use of both spaces or only one. See capacity breakdown chart later in this guide.

### Pricing

\$240 an hour

Minimum four hour rental

*Cityscape, English Bay, Northshore Mountains*

*Open Green Space and Bike Path*

*Sample patio setup*



### Ideal for

Wedding ceremonies and receptions, BBQs, corporate socials or special events, team building, meetings, conferences, a celebration of life, trainings, reunions and anniversaries, openings, youth events or camps.

### Included amenities

Event Liaison, security, building services staff, event storage space, site visits, signage and photo opportunities.

### A/V & Furniture

Wi-Fi, access to 15 six-foot rectangular banquet tables, and 50 blue plastic folding chairs. No A/V included - though you can rent a projector through us for an additional fee.

## Garden Patio & History Room



Floor Plan

# History Room

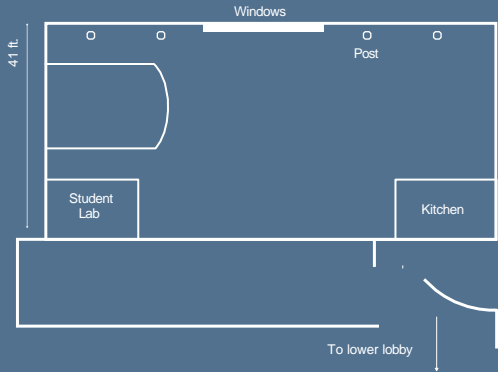

Floor Plan

# Garden Patio

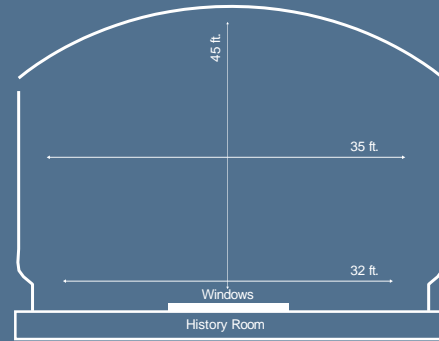

# Capacities

Capacities may vary depending on your event setup. From standing reception, theatre style, classroom style to seated dining and ceremonies, MOV could be your ideal choice for different events and ceremonies.

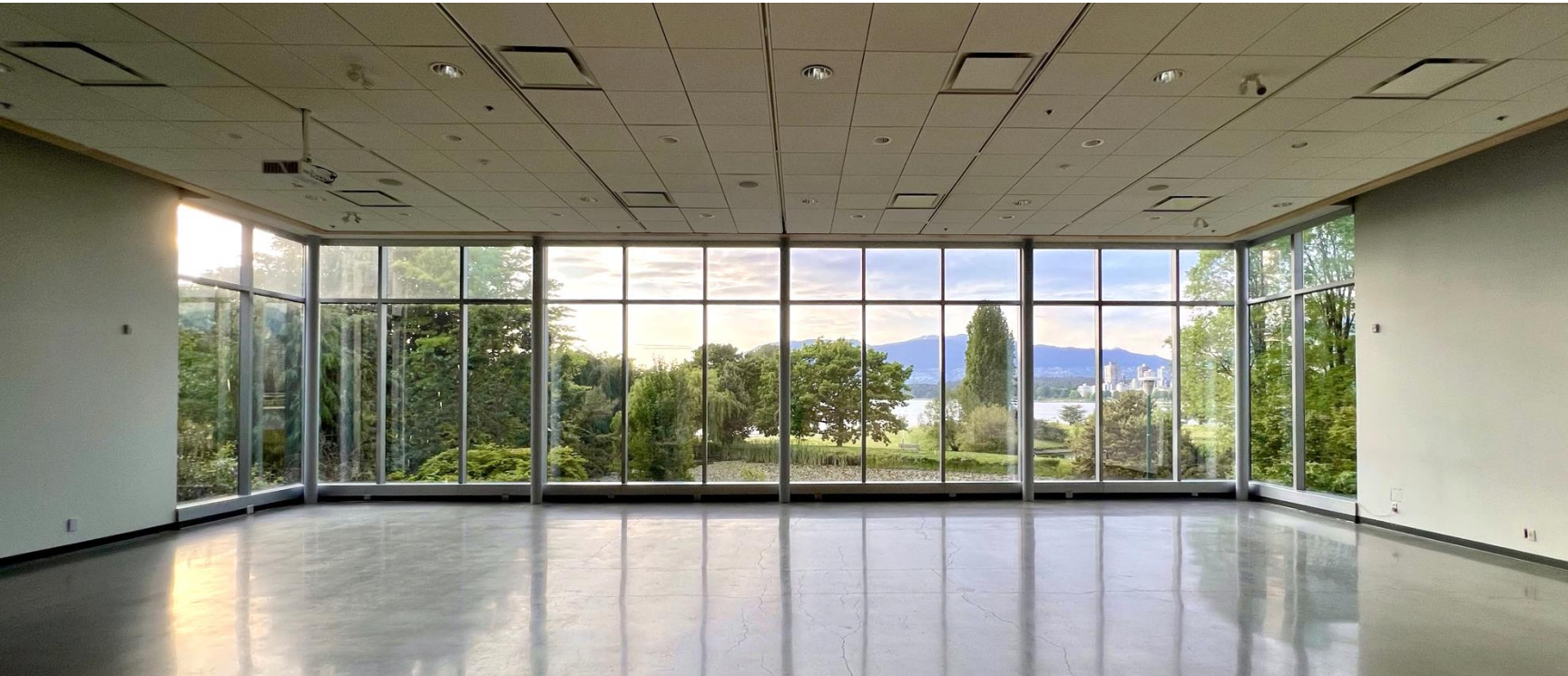

# Capacity Chart

	<b>Standing Reception</b>	<b>Theatre Style</b>	<b>Classroom Style</b>	<b>Seated Wedding Ceremony</b>	<b>Seated Dining</b>
<b>Joyce Walley Room</b>	140	120	100	120	90
<b>History Room</b>	60	50	40	50	40
<b>Garden Patio</b>	100	90	60	90	60





# Pricing

## Discounts

MOV Members	10% off
Non-Profit Groups	30% off

## Insurance

**Insurance is required** for all venue rentals at the Museum. You have the option to purchase insurance through the Museum or through an alternative provider. Proof of insurance will need to be submitted to our Rentals Department **fourteen (14) days prior to your event** or your event may be cancelled.

Liability	\$6 or \$60 (based on the nature of event)
Host Liquor Liability	\$100 (if applicable)





# Pricing

## Joyce Walley Room

(minimum 4 hours)

\$370 an hour

## Garden Patio & History Room

(minimum 4 hours)

\$240 an hour

**Available Rental Hours:** 7:00am – 12:00am

Make sure to include how much time you need for **setup and take down** when calculating your total rental costs.

All prices subject to GST.

### Planning a multi-day event?

Contact our rentals team directly at [rentals@museumofvancouver.ca](mailto:rentals@museumofvancouver.ca)



# Pricing

Additional fees, if applicable:

<b>SOCAN Music</b> (without dancing)	\$31.72
<b>SOCAN Music</b> (with dancing)	\$63.49
<b>Re:sound</b> (without dancing)	\$13.30
<b>Re:sound</b> (with dancing)	\$26.63
<b>After Hours Fee*</b> (Applies to any event occurring after operating hours)	\$100

\*Museum Hours: Sunday to Wednesday 10:00am - 5:00pm  
Thursday to Saturday 10:00am - 8:00pm





## Pricing

Optional services, if applicable:

<b>Projector</b> (Applicable to History Room only. Projector comes included with the Joyce Walley.)	\$100
<b>Exhibition Access</b> (with rental)	\$200
<b>Guided Tour</b> (minimum 10 people required)	Request for details



# Catering

## Peake of Catering

An industry-leading, full service catering company. It offers catering and event management for events from intimate to extravagant. Peake of Catering brings culinary and event solutions to a wide variety of dining requests through thoughtful planning, precision execution and delicious moments.

### Contact

Phone: 604.872.8431

Email: [info@peakeofcatering.com](mailto:info@peakeofcatering.com)

Website: [www.peakeofcatering.com](http://www.peakeofcatering.com)

## Edge

Vancouver's premiere catering company, led by female food entrepreneur Judy Reeves. The coveted caterer is renowned for its elevated, locally sourced, custom cuisine and flawless, detailed event management.

### Contact

Phone: 604.876.7226



---

Catered by Peake of Catering

# Contact

To get started with a booking, head to our website.  
Under the **Visit** tab, select **Venue Rentals** then **Book Now**.

**MOV Venue Rentals Department**  
P: 604-730-5320  
E: [rentals@museumofvancouver.ca](mailto:rentals@museumofvancouver.ca)

## Find us online



[@museumofvan](https://www.instagram.com/museumofvan)  
[museumofvancouver.ca](https://www.youtube.com/museumofvancouver.ca)



*by Shauna Danielle Photography*